



## Connectors

43M-ICA58-C03 / 43F-ICA58-C03  
 NM-ICA58-C03 / NF-ICA58-C03  
 716M-ICA58-C03 / 716F-ICA58-C03

## Installation Instruction

1000037117-01  
**Matching Cable Models: ICA58-50 Series**

These instructions are written for qualified and experienced personnel. Please study them carefully before starting any work. Any liability or responsibility for the results of improper or unsafe installation practices is disclaimed. Please respect valid environmental regulations for assembly and waste disposal. Always make sure to use appropriate personal protection!

The following installation instructions illustrate the process using a 4.3-10 connector as an example. The general installation steps apply to other connector types as well, including N-type, 7/16 DIN, and others, unless otherwise specified.

Other tools may be used to trim the cable per dimensions listed in figure 4.

### Tools (needed)



- Prep tool TRIM-ICA58-C03 (1 & 2)
- Open End Wrenches – 2 needed (1" or 26mm)
- Utility Knife
- Cutting Pliers
- Electric Drill
- Small toothed Saw

### Parts List (Included in the package)



- O-Ring
- Grease
- Connector Back Nut
- Connector Head

### Installation Steps

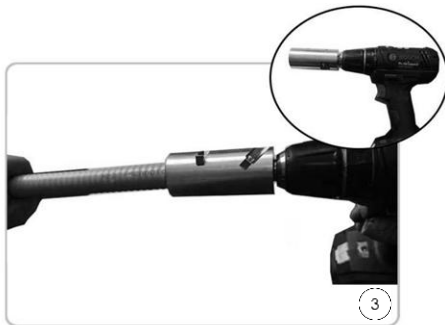

Use cable prep tool 1, to strip the cable

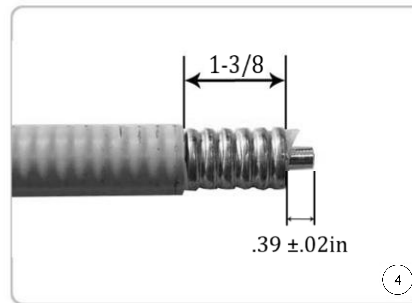

Dimension after stripping:  
 (35mm or 1-3/8)  
 The length of the inner conductor is  
 approximately:  
 (10 ±0.5mm or .39 ±.02in).

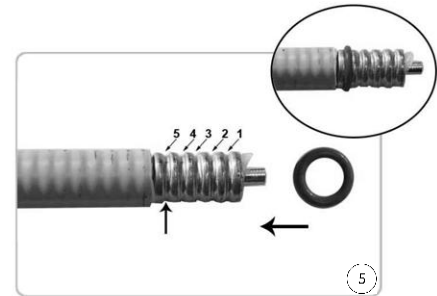

Set the O-ring at the 5th trough.



## Connectors

43M-ICA58-C03 / 43F-ICA58-C03  
 NM-ICA58-C03 / NF-ICA58-C03  
 716M-ICA58-C03 / 716F-ICA58-C03

## Installation Instruction

1000037117-01  
**Matching Cable Models: ICA58-50 Series**

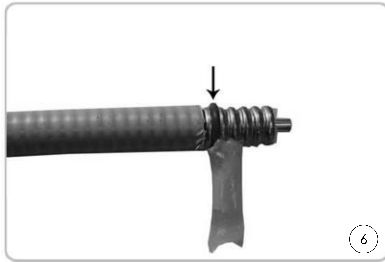

Grease the O-ring.

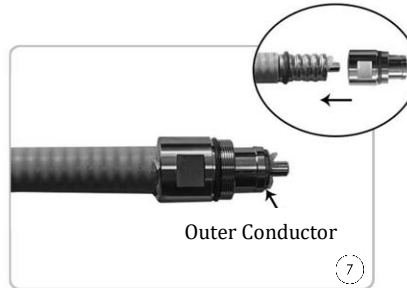

Slide the connector Back Nut over the cable end, pulling it forward until the outer conductor is fully exposed.

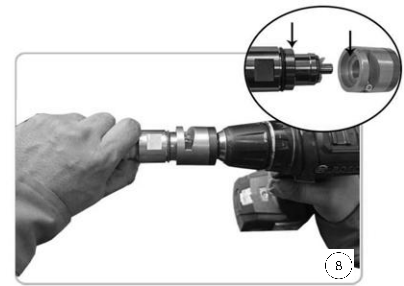

Use Cable Prep Tool 2 to chamfer the center conductor. Ensure that the inner step of the tool is positioned flush against the back edge of the connector Back Nut.

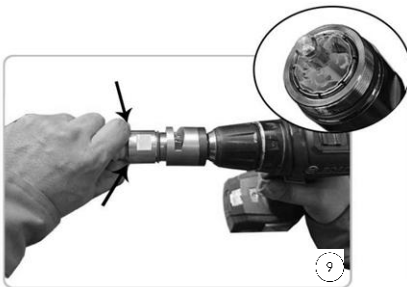

Press against the tail of the connector Back Nut and start stripping the cable.



Use a utility knife to remove dielectric burs.



If necessary, use cutting pliers to trim the dielectric.

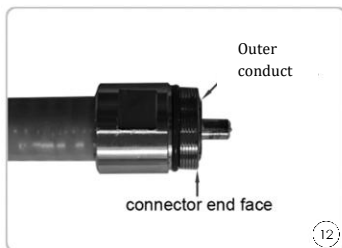

Ensure that the outer conductor of the cable is flush with the end face of the connector. A slight overhang is acceptable.

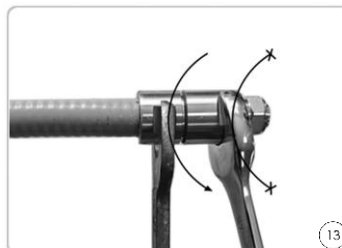

Keep the connector head steady, turn the connector Back Nut onto the connector head tightly. Recommended torque is: 26 ft-lbs (35 Nm).



Finished.