

**BOOT-CP-78**

Cushion plug for 7/8" feed through assemblies

Cushion inserts for 7/8" boot assemblies

FEATURES / BENEFITS

Cushion plug for unused holes in a boot entry. The plug is removable and allows a future expansion.

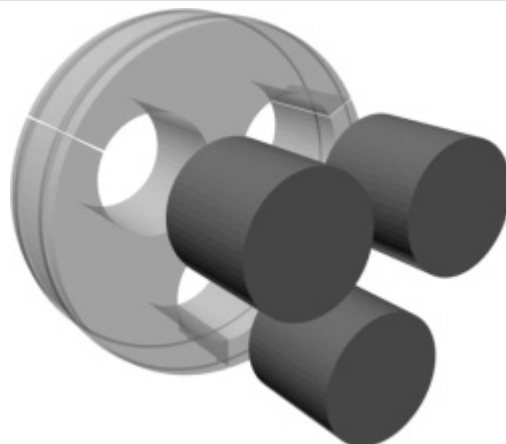
[External Document Links](#)[Notes](#)**Technical features****STRUCTURE**

Product Line		Coaxial Cable Accessories
Product Type		Wall/Roof Feed-Through System
Feed-Through Component		Boot Assembly
Transmission Line Type		LCF78, UCF78
Coaxial Cable Type		Foam Dielectric
Cable Size		7/8"

MECHANICAL SPECIFICATIONS

Mated to Cable Size and Interface		7/8
Color		Black
Material		EPDM rubber

TEMPERATURE SPECIFICATIONS

Operation Temperature, °C(°F)	°C(°F)	-50 to 85 (-58 to 185)
Storage Temperature	°C(°F)	-50 to 85 (-58 to 185)

PACKAGING INFORMATION

Package Quantity		5
------------------	--	---