

**RCA12-50JPL****1/2" PLENUM rated RADIAFLEX® RCA12 Cable**

- RFS Technologies' First Plenum Rated Radiating Cable, certified and listed by ETL to UL444, tested to NFPA262 Plenum Rating.
- RADIAFLEX® functions as a distributed antenna to provide communications in tunnels, mines and large building complexes and is the solution for any application in confined areas.
- Slots in the copper outer conductor allow a controlled portion of the internal RF energy to be radiated into the surrounding environment. Conversely, a signal transmitted near the cable will couple into the slots and be carried along the cable length.
- RADIAFLEX® is used for both one-way and two-way communication systems and because of its broadband capability, a single radiating cable can handle multiple communication systems simultaneously.
- This RADIAFLEX® radiating cable utilize a low-loss cellular polyethylene foam dielectric and a corrugated copper outer conductor which offers a combination of remarkable flexibility, high strength and excellent electrical performance.

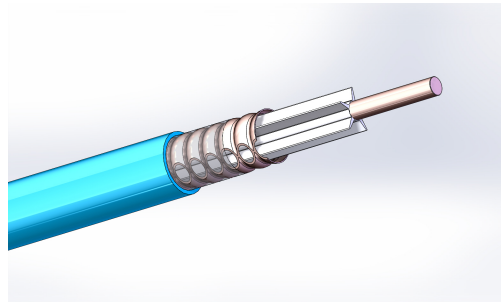

RCA PLENUM Radiating Cable

FEATURES / BENEFITS

- Certified and Listed by ETL to UL444, tested to NFPA262 Plenum Rating
- Broadband radiating cable supporting all wireless applications between 75 MHz to 6000 MHz
- Ideally suited for application that require low bending radii
- Robust radiating cable operational under all enviromental conditions as e.g. harsh tunnels or mines
- Ideal for In-train, Vehicle-to-Everything communication and In aircraft to wireless/satellite networks

Technical features**GENERAL SPECIFICATIONS**

Size		1/2
------	--	-----

ELECTRICAL SPECIFICATIONS

Max. Operating Frequency	MHz	6000
Cable Type		RCA
Impedance	Ohm	50 +/- 2
Velocity, percent	%	88
Capacitance	pF/m (pF/ft)	76 (23.2)
Inductance, uH/m (uH/ft)	μH/m (μH/ft)	0.19 (0.058)
DC-resistance inner conductor, ohm/km (ohm/1000ft)	Ω/km (Ω/1000ft)	1.48 (0.45)
DC-resistance outer conductor, ohm/km (ohm/1000ft)	Ω/km (Ω/1000ft)	2.23 (0.68)
Stop bands	MHz	2800-2900
Frequency Selection	MHz	600, 900, 1800/1900, 2200, 2400, 2500, 2700, 6000

**MECHANICAL SPECIFICATIONS**

Jacket		JPL
Jacket Color		Standard Blue, other colors on request
Jacket Description		PLENUM Rated, Halogen free, non corrosive, flame and fire retardant, low smoke, polyolefin + flame barrier tape above outer conductor for lowest cable loss
Slot Design		Milled (Two-Row)
Inner Conductor Material		Copper Clad Aluminum Wire
Outer Conductor Material		Corrugated Copper Tube
Diameter Inner Conductor	mm (in)	4.8 (0.19)
Diameter Outer Conductor	mm (in)	13.8 (0.54)
Diameter over Jacket Nominal	mm (in)	16.2 (0.64)
Minimum Bending Radius, Single Bend	mm (in)	127 (5)
Cable Weight	kg/m (lb/ft)	0.246 (0.165)
Tensile Force	N (lb)	1000 (221)
Indication of Slot Alignment		None
Recommended / Maximum Clamp Spacing	m (ft)	0.6 (2)
Minimum Distance to Wall	mm (in)	50 (1.97)

TESTING AND ENVIRONMENTAL

Jacket Testing Methods		ETL Listed to UL444, NEC 820-53 (a) CMP, NFPA-262, Canadian CSA C.22.2/FT6 IEC 60754-1/-2 smoke emission, halogen free, non corrosive IEC 61034 low smoke IEC 60332-1 flame retardant IEC 60332-3-24 fire retardant
------------------------	--	---

TEMPERATURE SPECIFICATIONS

Storage Temperature	°C(°F)	-40 to 85 (-40 to 185)
Installation Temperature	°C(°F)	-20 to 60 (-4 to 140)
Operation Temperature	°C(°F)	-40 to 85 (-40 to 185)

**ATTENUATION**

Frequency, MHz	Longitudinal Loss, dB/100 m (dB/100 ft)	Coupling Loss 50%, dB	Coupling Loss 95%, dB
75	2.20 (0.67)	50	62
150	3.15 (0.96)	59	71
450	5.70 (1.74)	64	75
800	7.83 (2.39)	65	77
870	8.23 (2.51)	65	77
900	8.40 (2.56)	65	77
960	8.65 (2.64)	65	77
1700	12.39 (3.78)	65	77
1800	12.87 (3.92)	65	77
1900	13.28 (4.05)	65	77
2000	13.87 (4.23)	65	77
2200	14.71 (4.49)	65	77
2400	15.68 (4.78)	65	77
2600	16.53 (5.04)	65	77
3500	19.52 (5.95)	65	77
3550	19.90 (6.07)	65	77
3600	20.03 (6.11)	65	77
3700	20.27 (6.18)	65	77
3980	21.21 (6.47)	65	77
4200	22.21 (6.77)	65	77
4900	25.15 (7.67)	65	77
5000	25.65 (7.82)	65	77
5200	26.74 (8.15)	65	77
5800	29.68 (9.05)	65	77
5925	30.27 (9.23)	65	77
6000	30.58 (9.32)	65	77

External Document Links

[rca12-50jplr.vex](#)

Notes

- Coupling loss as well as longitudinal attenuation of RADIAFLEX® cables are measured by the free space method according to IEC 61196-4.
- Coupling loss values are average values of all three spatial orientations (radial, parallel and orthogonal) of dipole antenna.
- Coupling loss values are given with a tolerance of +10 dB and longitudinal loss values with a tolerance of +5%. Note: Measured



RCA12-50JPL

1/2" PLENUM rated RADIAFLEX® RCA12 Cable

- values below nominal are better. They are not limited by any tolerance-range.
- As with any radiating cable, the performance in building or tunnel environments may deviate from figures based on free space method.